

CT-60.1 Sepax™ C-Pro Kit

SEPAX C-PRO CELL PROCESSING SYSTEM

The CT-60.1 Kit is integral to our Sepax C-Pro Cell Processing System. It provides a functionally closed environment and is for single-use only.

Key features

| Part | Name | Description |
|------|----------------------------|--|
| 1 | A-200/B separation chamber | Enables centrifugation, capacity of 220 mL |
| 2 | Pressure monitor | Luer port with 0.2 µm bacterial filter to connect to the pressure sensor |
| 3 | Stopcock manifold | Three automatically controlled rotational valves to direct fluid flow |
| 4 | Initial line | Connects the kit to the initial bag |
| 5 | Washing solution line | Connects the kit to the washing solution bag |
| 6 | 1000 mL bag | PVC bag to collect by-product |
| 7 | Final line(s) | Connects the kit to the final bag |
| 8 | Double spike extension | Extension line for connecting the initial bag via a double connection |
| 9 | Single spike extension | Extension line for connecting the initial bag via a single connection |

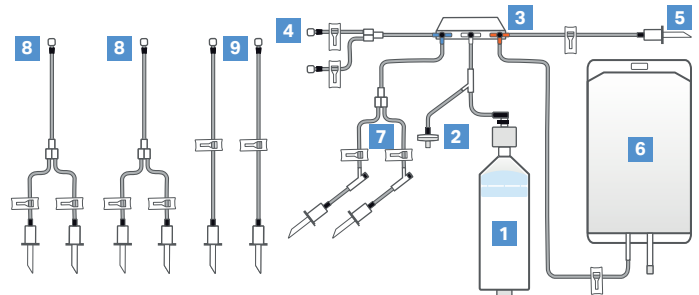

Fig 1. Diagram showing components of CT-60.1 Sepax C-Pro Cell Processing Kit.

Storage requirements

Store kits in a clean and dry environment without chemical or biological contamination within the following conditions:

| | Operation | Storage and transport |
|-------------------|---------------------------|---------------------------|
| Temperature | 7°C to 27°C | 4°C to 40°C |
| Relative humidity | 30% to 75% non-condensing | 20% to 75% non-condensing |

Product specifications

Only for use with Sepax C-Pro instrument and compatible application software (see table below).

| | |
|---------------------------------|---|
| Shelf life | Two years from the date of manufacture |
| Sterility | Ethylene oxide, non-pyrogenic |
| Material | Standard medical grade PVC, PP, POM, PC, ABS, and silicone |
| Tubing | All the tubes are made of PVC and are compatible with sterile connections. External diameter is 4 mm. |
| Compatible application software | PlateletFree C-Pro, BeadWash C-Pro, SpinOcultation C-Pro, CultureWash C-Pro, Dilution C-Pro |

Ordering information

| Product | Product code |
|--|---------------------|
| CT-60.1 Sepax C-Pro Cell Processing Kit | 29264739 |
| <ul style="list-style-type: none">• Each kit is packed in an individual blister sealed with a Tyvek™ cover• Minimum order: Box of 6 kits (dimensions: 33 × 35 × 26 cm, 13 × 14 × 10 in) | |

| Related products | Product code |
|--|---------------------|
| Sepax C-Pro Cell Processing Instrument | 29264741 |
| Sepax C-Pro applications software pack | 29734656 |
| CPAK-100 Sampling Line | 29275109 |
| CPAK-101 Sampling Line | 29275108 |

[cytiva.com/celltherapy](https://www.cytiva.com/celltherapy)

Cytiva and the Drop logo are trademarks of Life Sciences IP Holdings Corporation or an affiliate doing business as Cytiva. Sepax is a trademark of Global Life Sciences Solutions USA LLC or an affiliate doing business as Cytiva. Tyvek is a trademark of E.I. du Pont de Nemours and Company. All other third-party trademarks are the property of their respective owners.

© 2020–2023 Cytiva

For local office contact information, visit [cytiva.com/contact](https://www.cytiva.com/contact)

CY14613-17Oct23-DF

